

# Abel Yard

## HARBOURSIDE

APPROXIMATE FLOOR AREA  
68 SQM / 730 SQFT

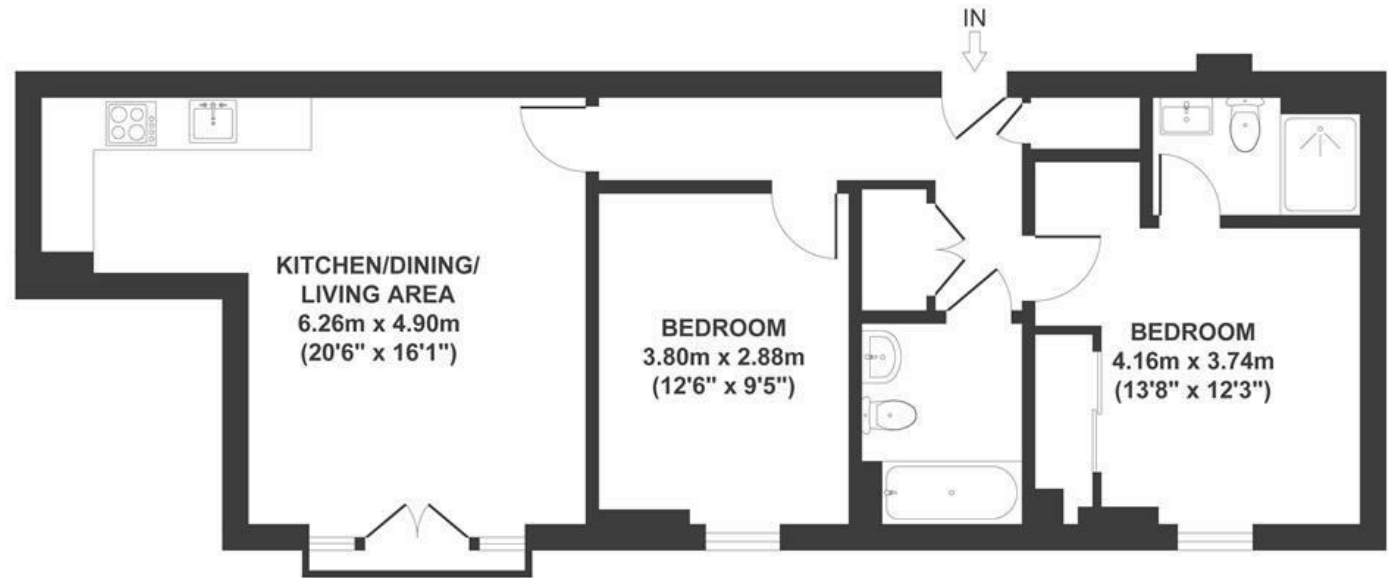

**Boardwalk**

# The Gateway , BRISTOL

£

£375,000



BS1 6ZP

zzz

2 Bedrooms



2 Bathrooms

*"Being able to walk out of the flat and enjoy a coffee or a pint from one of the brilliant independent restaurants and cafes. The location is so perfect, everywhere in the city is accessible from Wapping Wharf the cargo boxes are brilliant for a wide range of food too!"*

